

## Rustic Shiplap Installation Instructions

### Tools needed

- Safety Glasses
- Pencil or pen
- Smooth face hammer
- Pneumatic nail gun
- Square (speed square)
- Level
- Portable power saw (miter saw)
- Fine tooth Carbide tipped saw blades

### Preparation

- It is ideal to store the product inside, out of the weather. If this is not possible protect Edge materials from the elements with a breathable waterproof cover, allowing air to circulate. Store off the ground on a stable surface free from moisture.
- Allow the wood to acclimate for several days prior to installation in the room in which it will be installed. Variances in temperature and moisture between the storage and application areas can have a negative effect on the finished appearance.
- As wood dries, a slight joint may open up. It is recommended to paint the surface behind the wood a dark color.
- Check with local building code to make sure all applicable standards are met.

### Before installation

- Ensure product profile, color and quality meet expectations. Installation of material will be considered as acceptance of quality. Do not install material deemed defective.

### Installation

1. Cutting/Machining  
The use of common woodworking tools is recommended. Power saws with a carbide-tipped combination blade work best. Always cut into the finished face for best results.
2. Ensure nails are set deep enough not to impede the installation of the next piece. Fasten shiplap directly to the wall framing when installing in a horizontal orientation. Always start horizontal installation at the bottom of a wall or the edge of a ceiling for ceiling applications. For vertical applications, full-length furring strips must be installed 24 inches on-center or less when fastening shiplap. Fasten shiplap using standard or painted trim nails (15 or 16 gauge). Fastener length should be long enough for 1 1/4"-1 1/2" of penetration into solid wood.
3. When installing shiplap over plaster or hardboard, the walls need to be in moderately good condition. Construction adhesive may be used if additional strength is desired but will not replace the need for fasteners. Apply trim nails in the shiplap tongue every 24 inches.
4. The overlapping profile allows for each board to fit snugly next to each other. Drive one fastener through the face above the overlap, and one fastener through the top flange of each board as you make your way up your wall or across your ceiling.
5. You may need to trim the final board to fit the dimension of your wall or ceiling. Use a table saw or circular saw to trim lengthwise. Take care to avoid fastening through the overlap of two pieces.

### Touch up and cleaning

For touch up paint information and supplies, visit [ufpEDGE.com](http://ufpEDGE.com). Touch up paint is intended to be applied sparingly to small imperfections. Test touch up paint to achieve desired result. Charred Wood products go through a proprietary color formulation process, therefore an exact paint match is not guaranteed. To clean, apply mild soap and water to smooth cloth and wipe surface.

Note: Edge products are not suitable for structural use. They may not be used for load-bearing applications. The same commonsense precautions should be taken when handling the products as with any wood or other building materials. Dust masks and eye protection devices are recommended to avoid possible irritation from sawdust and chips. Gloves will help protect hands. Hands should be washed after construction work.

THE DIAGRAMS AND INSTRUCTIONS IN THIS BROCHURE ARE FOR ILLUSTRATION PURPOSES ONLY AND ARE NOT MEANT TO REPLACE A LICENSED PROFESSIONAL. ANY CONSTRUCTION OR USE OF THE PRODUCT MUST BE IN ACCORDANCE WITH ALL ZONING AND/OR BUILDING CODES. THE CONSUMER ASSUMES ALL THE RISKS AND LIABILITY ASSOCIATED WITH THE CONSTRUCTION OR USE OF THIS PRODUCT. THE CONSUMER OR CONTRACTOR SHOULD TAKE ALL NECESSARY STEPS TO ENSURE THE SAFETY OF EVERYONE INVOLVED IN THE PROJECT, INCLUDING, BUT NOT LIMITED TO, WEARING THE APPROPRIATE SAFETY EQUIPMENT. UFP EDGE, LLC, DOES NOT PROVIDE ANY WARRANTY, EITHER EXPRESS OR IMPLIED, AND SHALL NOT BE LIABLE FOR ANY DAMAGES, INCLUDING CONSEQUENTIAL DAMAGES.

### Installation

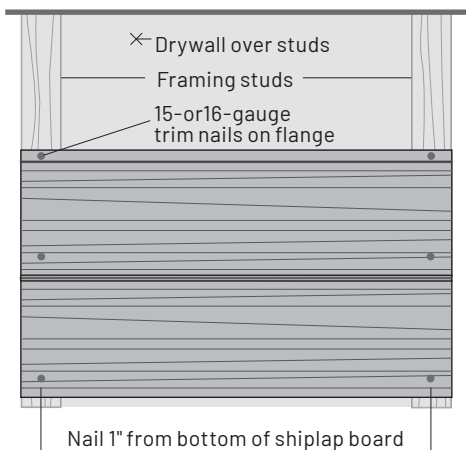

### 1 | Horizontal Configuration

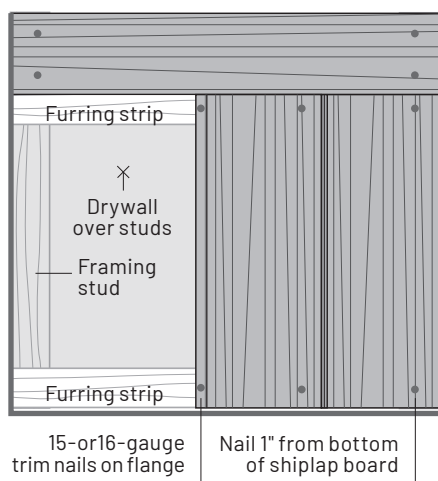

### 2 | Vertical Configuration



**UFP** RETAIL SOLUTIONS

A UFP INDUSTRIES COMPANY

2801 East Beltline NE | Grand Rapids, MI 49525 | 800.598.9663 | [UFPi.com](http://UFPi.com)

25008 03/25